



<https://cloudblue.com>

[Documentation](#)  [Help and Support](#)  [Release Notes](#) 

v39 Release Notes



This article has been generated from the online version of the documentation and might be out of date. Please, make sure to always refer to the online version of the documentation for the up-to-date information.

Auto-generated at December 19, 2025



Release Date: **November 3, 2025**

This release brings new and enhanced features, better scalability, smoother workflows, and a richer user experience on Connect.



1. CloudBlue Connect Platform

1.1 Multi-Factor Authentication support

Partners can now enable CloudBlue Connect's Multi-Factor Authentication (MFA) support for their accounts, significantly boosting the security of the platform access and business operations.

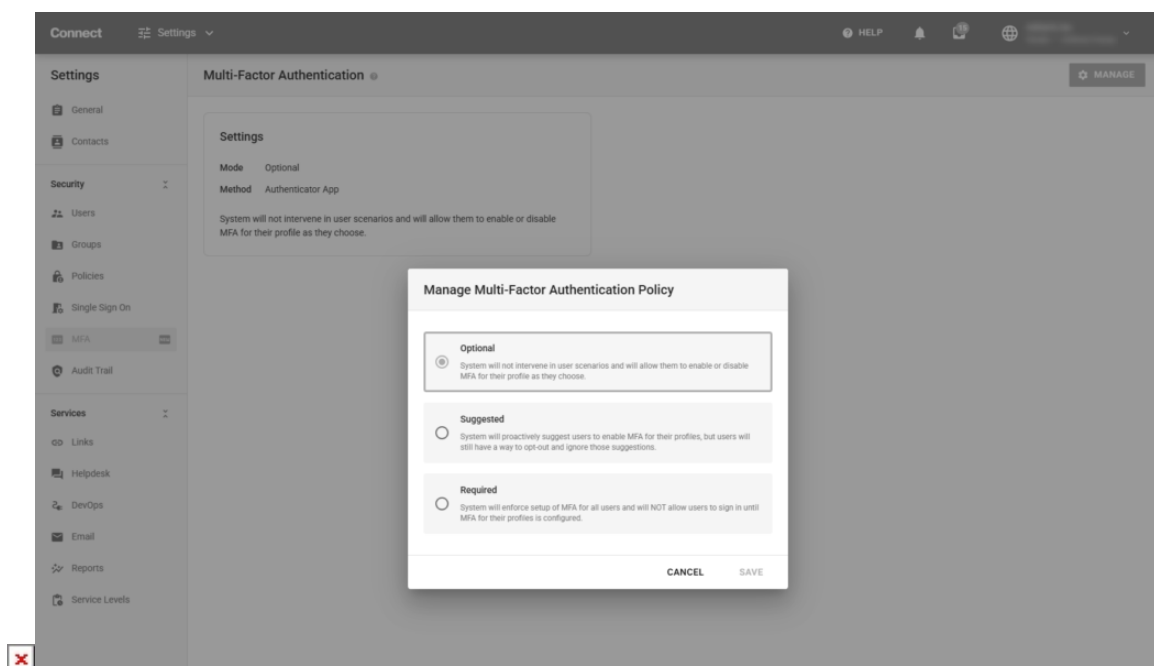



Users can navigate to their **User Profile** settings within CloudBlue Connect to set up their preferred second factor (e.g., using an authenticator app like Google Authenticator or Microsoft Authenticator).

Read more about Multi-Factor Authentication [here](#).

1.2 Item-to-Item Mapping for Switch Paths

As part of CloudBlue Offers, Switch Paths now supports Item-to-Item mapping, significantly enhancing the product life cycle management for our partners. This new functionality provides Vendors and Distributors with unprecedented precision and control when managing subscription upgrades, downgrades, and other changes.

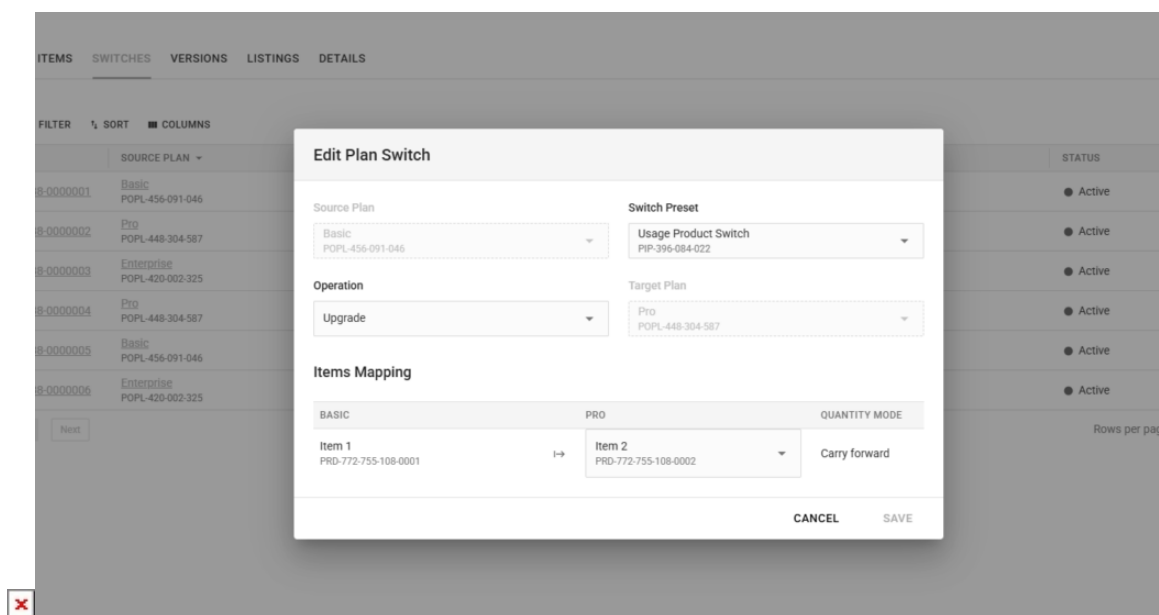

With Item-to-Item Mapping, partners can now define exactly how individual components (Items/SKUs) within the subscription transfer during a switch path.

1.3 Support right to left (RTL) languages

CloudBlue Connect has expanded its localization capabilities for our partner's end customers working with the platform in regions primarily utilizing right-to-left languages such as Arabic, Hebrew, and Persian.

The platform's customer portals – such as inquiring and activation templates – will now experience a user interface that accommodates the flow of these languages.

1.4 Performance & Security Updates

We have enhanced multiple aspects of our platform to boost performance, optimize operational efficiency, and strengthen security across various areas.